

RESTORATION OF THE QUARTER CORNER  
COMMON TO SECTIONS 17 AND 20, T3N, R9W, W.M.

At the corner I find the 1-1/2" iron pipe with 2-1/2" brass cap, top 2" above ground, set by Wayne Cook, LS 1098, in May 1986, as recorded on Tillamook County Survey A-5357. Cook's B.T.'s bear as follows: the 9" hemlock at N77°E 42.0 ft. is now a 12" hemlock that bears N77°E 42.03 ft. to an 8" spike I set in notch at base of partially overgrown face. The 8" alder at S22°E 4.80 ft. is now a 13" alder that bears S22°E 4.48 ft. to an 8" spike I set in notch at base of bark scribe. Set a 6' steel fence post with location tag 2' south of corner.

**Note:** Bearings reported to bearing trees are hand compass bearings using a declination of 21 1/2° east.

Field work by A. Hofmann & R. Erickson on 7/22/99  
Field examined and approved by K. Foeste, LS 849, on 11/8/99

Karl F. Foeste  
361 S.W. Main Ct.  
Warrenton OR 97146

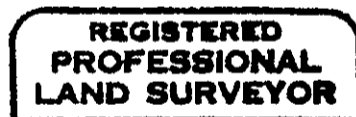

*Karl F. Foeste*



Renews 1/1/2000